



# JUSTSERVE

## COMMUNITY SERVICE OPEN HOUSE

**THURSDAY FEB. 2 | 6-8 PM | 12040 W AMITY RD**

JOIN THE CHURCH OF JESUS CHRIST OF LATTER-DAY SAINTS,  
THE BAHÁ'Í OF MERIDIAN & STONEHILL CHURCH IN A NIGHT OF SERVICE



### ✓ **SERVE WITH FRIENDS**

Invite your friends and neighbors to serve our community by helping with a variety of group projects at the 2nd Annual JustServe Community Service Open House!



### ✓ **DONATE SUPPLIES**

Canned or Boxed Food  
Old Eye Glasses  
Plastic Grocery Bags  
Reusable Grocery Bags  
Paper Towels  
Laundry, Dish or Hand Soap  
All-Purpose Spray Cleaner  
Trash Bags & Sponges  
Kitchen Towels & Washrags  
Pot Holders



### ✓ **VOLUNTEER or DRIVE-BY**

Come inside the church and serve anytime between 6-8 PM. All ages welcome! Or drive-by with canned food, old eyeglasses, plastic grocery bags, or kitchen kit donations at the back entrance of the church. See map below for details.

## BUILDING UNITY THROUGH COMMUNITY SERVICE

JustServe.org is a free website and app used by faith, nonprofit, community, and government organizations to post service opportunities that allow the entire community to find voluntary opportunities to assist those in need.



**Find us near the corner of  
Amity & Cloverdale Rd.**



[JustServe.org](https://JustServe.org) & [Apple](#) & [Google Play](#) App



@JustServeTreasureValley



[JustServeSWBoise@JustServe.org](mailto:JustServeSWBoise@JustServe.org)

# CHURCH BUILDING MAP

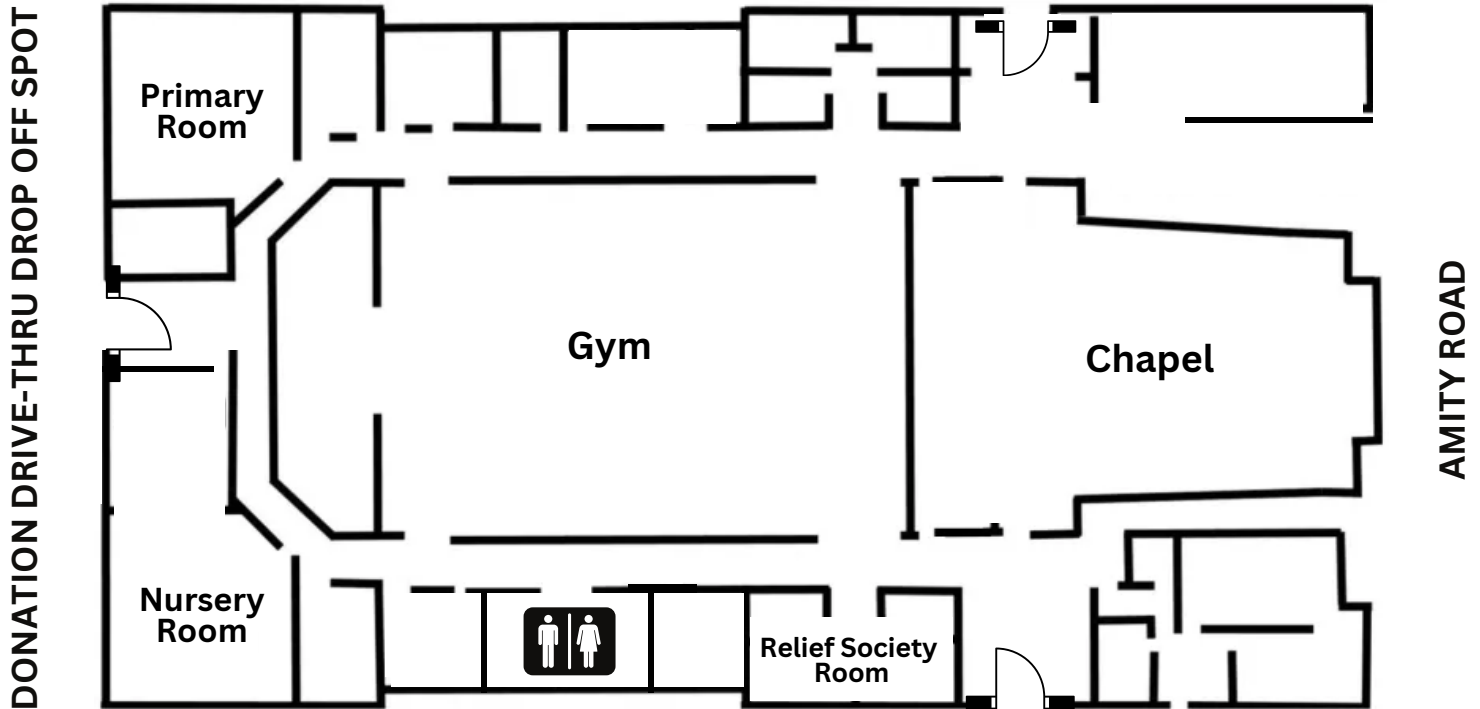

Invite your friends and neighbors to serve our community at the 2nd Annual JustServe Community Service Open House on Thursday, February 2nd from 6-8 PM at the Church of Jesus Christ of Latter-day Saints located at 12040 W Amity Road in Boise. At this event, there will be a variety of ways to serve for youth and adults of all ages. You can drive by and drop off donations of old eyeglasses, canned or boxed food, plastic grocery bags, or kitchen kit items at the north entrance of the church. Or you can come inside and stay a while and find a service project to do!

## What Projects are We Serving?

For more information about each project visit their JustServe or website link

- Donating Used Eyeglasses to Lions Club Recycle for Sight Program - **DROP OFF BOX INSIDE ENTRANCES & DRIVE-THRU**
- Donating Non-perishable Food to Shepherd of the Valley - **DROP OFF BOX INSIDE ENTRANCES & DRIVE-THRU**
- Donating Supplies & Assembling Kitchen Kits for West Ada Community Schools - **GYM & DRIVE-THRU**
- Assembling Know Your Worth Trauma Training Packets for Safe Families - **GYM**
- Creating The Virtues Project Teaching Packets for Children's Classes - **GYM**
- Assembling Materials for the English Language Center - **GYM**
- Making Art for the Elderly for Letters to Rose - **GYM**
- Creating Valentines for Copper Springs Senior Living - **GYM**
- Writing Letters to the Idaho Youth Challenge Academy - **GYM**
- Quilt Tying for Refugee Organization Glocal - **NURSERY ROOM**
- Making Burp Cloths for the Canyon County Branch of the Assistance League of Boise - **PRIMARY ROOM**
- Donating Plastic Grocery Bags and Making Sleeping Mats for Homelessness - **RELIEF SOCIETY ROOM & DRIVE-THRU**





## COMMUNITY SERVICE OPEN HOUSE FAQs

- **Do I have to stay the whole time?** No, it's open house style, so you can come anytime between 6-8 PM to volunteer and stay as long as you want.
- **Do I have to come inside to serve?** No, there is a drive-thru service option for people to drop off donations with our volunteers at the north entrance of the church (see map), or people can come in and join a service project inside.
- **Do I have to bring a donation to the JustServe Community Service Open House?** No, bringing donations to the JustServe Community Service Open House is totally optional, there are many different ways to serve that night.
- **Is there a drop-off box for donations before the JustServe Community Service Open House?** No, we are accepting donations between 6-8 PM at the JustServe Community Service Open House on February 2nd. If you need to make special arrangements contact Bryn Booker at [JustServeSWBoise@JustServe.org](mailto:JustServeSWBoise@JustServe.org).
- **Where do I learn more about the organizations being served?** There are links to the JustServe pages or websites for most of the organizations under "What projects are we serving?"
- **Can I bring children to the JustServe Community Service Open House?** Yes! This event is for all ages, we have coloring pages and valentines to make for nursing home residents which will be a great way for young children to give service.
- **Are only members of the Church of Jesus Christ of Latter-day Saints, Stonehill Church, or The Bahá'í of Meridian invited?** No, this is a service activity for the entire community! The goal of this event is to build unity in our community through service!
- **What if I can't come to the Open House but I still want to serve?** You can find many ways to serve the community at [www.JustServe.org](http://www.JustServe.org). You can search for a remote or local project that fits your schedule and interests.
- **I want to learn more about JustServe, who should I contact?** Contact JustServe Specialist Bryn Booker at [JustServeSWBoise@JustServe.org](mailto:JustServeSWBoise@JustServe.org)

